



Shorefield Mount

Bolton, BL7 9EN

£299,950



Shorefield Mount is a well-established, quiet, and secluded development in Egerton, and is home to this spacious, three-bedroom, semi-detached house which benefits from contemporary interiors and a fantastic plot. The property offers three double bedrooms, a generous family bathroom, two reception rooms, kitchen with breakfast dining area, plenty of storage, tandem drive, garage, and gardens to front and rear!

If you're looking for a lovely family home in a quiet location this might just be the one. Let's step inside...



Spacious, Contemporary Interiors

Entering through the front door you are welcomed into an entrance vestibule which then brings you into the lounge – a spacious room with oak flooring, modern décor and log burner. Running the width of the property to the rear is the second reception room – another good-sized room where stylish wood-style tiled flooring bounces natural light around the space, pouring in through the French doors and windows that open onto the patio. Owing to its generous size the current homeowners utilise this second reception space as a dining room, as well as an additional lounge, which serves as a peaceful place to relax and unwind. Or perhaps this space could be used as a playroom for the kids?

Next to the lounge at the front is the kitchen, another well-presented, modern space that is perfect for family life. The kitchen is styled with white brick wall tiling, contrasting light grey deep drawers and cupboards, and an anthracite grey unit standing opposite, which houses more cupboard space as well as two integral AEG ovens. Sitting atop the white Quartz worktop is a five-plate gas hob with extractor, and to the front end of the kitchen is a breakfast bar, ideal for socialising with family and friends.

Bedrooms & Bathing

Up the stairs leading through the centre of the home, and you're welcomed onto the landing connecting the three double bedrooms and family bathroom. Complementary anthracite doors and architraves, wooden balustrade and handrail, and feature radiators bring a touch of contrast to the light grey carpets and fresh white walls.

Each of the three double bedrooms is well proportioned with neutral décor, and the family bathroom is just fantastic! Exuberant, feature tiling and a free-standing orange tub with chrome finishes brings this room to life. A complementary chrome heated towel rail and white feature radiator sits on a white brick tiled wall, bringing more subtle character to the space. A three-piece suite includes the tub with waterfall showerhead, feature wash basin with chrome piping, and WC.

Outside Space

Externally, the property sits in a lowered position behind the front garden, adding an element of privacy. A long tandem drive leads down the left side of the property to the converted garage. To the rear, a patio sits in front of the glass doors outside the second reception room, where a few stone steps bring you down to a lawn, decking, and another patio.

Welcome to Shorefield Mount

Shorefield Mount is a well-established and secluded development in Egerton, where rural walks, cafes, pubs, and restaurants are all within walking distance. Benefitting from a quiet, family friendly environment while being close to the village amenities of Egerton and Bromley Cross, as well as a great selection of nurseries and schools, this spot is more than ideal for a growing family!

Bromley Cross train station is only a 5-minute drive from this property, allowing for easy access into Manchester, elsewhere in the Northwest, and beyond. The A666 is right on your doorstep too, providing easy motorway access as well as short drive into central Bolton.

Area Map



Floor Plans

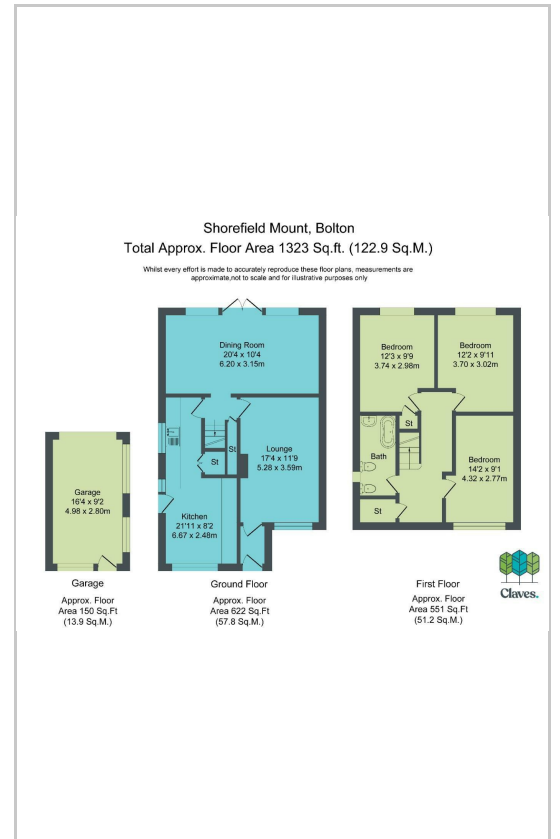

Energy Efficiency Graph

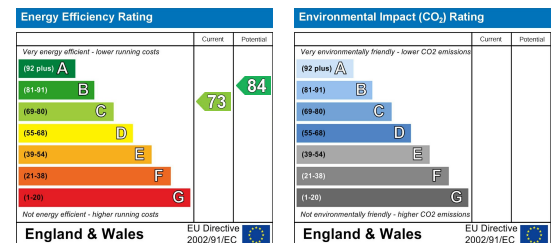

These particulars, whilst believed to be accurate are set out as a general outline only for guidance and do not constitute any part of an offer or contract. Intending purchasers should not rely on them as statements of representation of fact, but must satisfy themselves by inspection or otherwise as to their accuracy. No person in this firm's employment has the authority to make or give any representation or warranty in respect of the property.

Claves.

Claves House, 295D Darwen Road, Bromley Cross, BL7 9BT.
t. 01204 929 940 | e. info@claves.co.uk | w. claves.co.uk